

3D Tool management

The innovation for your production!





3D Tool Management

The innovation for your production!

Interface to SolidWorks®

In order to meet the demands of today's highly complex tooling machines and machining processes, more and more companies are betting on coherent 3D-CAD/CAM solutions. This means that the tools and devices used generally have to be set up redundantly in the different systems – the tool database, the CAM system and the simulation software.

The FATool 3D Tool and Operational Resources Management sets new standards in this discipline. FATool uses existing CAD systems for the 3D design of tools and devices and transfers them directly to the CAM systems or simulation programs along with the required technical parameters. Hence, only one definition is needed for all systems involved!

In conjunction with SolidWorks®, FATool reduces the creation of 3D tools and 3D devices to the unique definition in the central FATool resource management. Tool and fixture components are stored as 3D volume models using SolidWorks® in FATool. From these components SolidWorks® complete tools and devices, partially fully automatic, are generated and stored as 3D assemblies in FATool. For NC programming and simulation, these assemblies are then converted into the correct graphics format as a 3D tool or 3D device at the push of a button, provided with all necessary technical parameters and made available to the corresponding CAM system.

The key functions at a glance:

- Automatic generation of tool and device components from parameter models
- Upload and prepare any manufacturer's model (STEP, X_T ...)
- Automatically adopt and prepare models in compliance with DIN 4003
- Assemble tool assemblies automatically and adopt the assembly
- Define multi-blade tool assemblies
- Define adjustable, automatically controlled tool assemblies
- Archive tools in other formats (STEP, STL, DXF ...) for different applications
- A master model package with approx. 20 parametric models is available

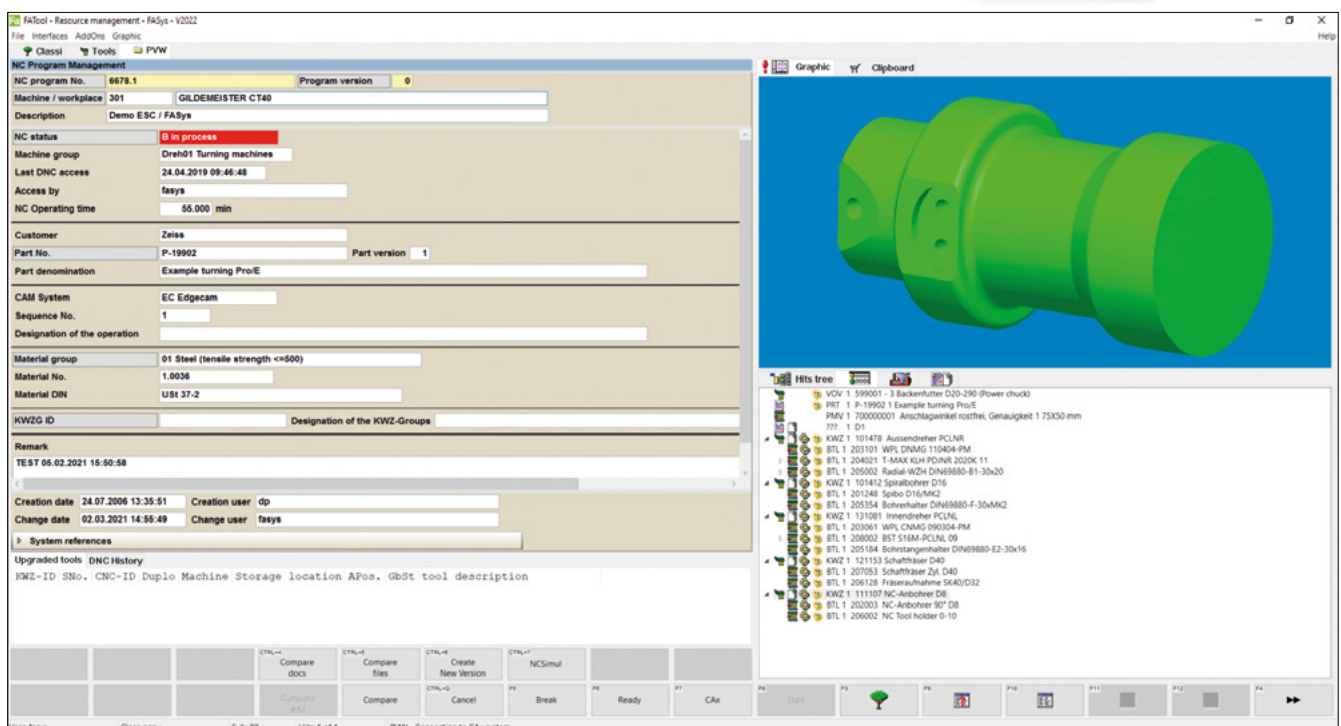
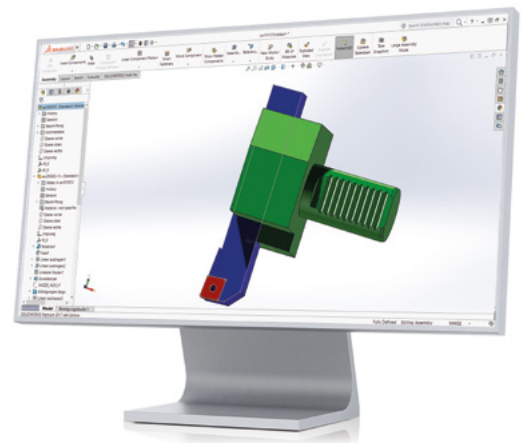



Hexagon is a global leader in sensor, software and autonomous solutions. We are putting data to work to boost efficiency, productivity, and quality across industrial, manufacturing, infrastructure, safety, and mobility applications.

Our technologies are shaping urban and production ecosystems to become increasingly connected and autonomous – ensuring a scalable, sustainable future.

Hexagon's Manufacturing Intelligence division provides solutions that utilise data from design and engineering, production and metrology to make manufacturing smarter. For more information, visit hexagonmi.com.

Learn more about Hexagon (Nasdaq Stockholm: HEXA B) at hexagon.com and follow us [@HexagonAB](https://twitter.com/HexagonAB).